

METAL FRAME KIT®

Directions:

Easily assemble
with a screwdriver.

1. Insert a set of L plates into back channel with Nielsen facing up.

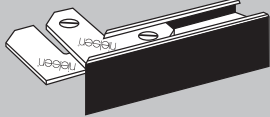

2. On a smooth surface join 3 sides with L plates by aligning corners and tightening screws.

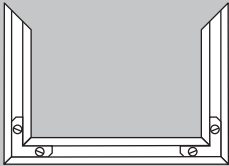

3. Slide glass, mat, art and back into 3-sided frame. Attach final side.

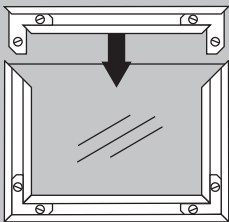

4. Insert spring clips to snugly press contents to front of frame.

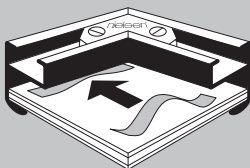

5. Wall hanger snaps into channel.

WOOD FRAME KIT®

Directions:

Easily assemble
in minutes.

1. Apply small amount of wood glue to one surface of adjoining corners.

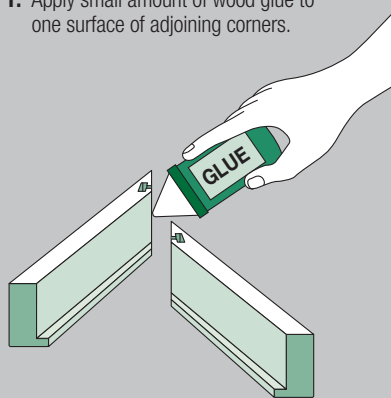

2. On a smooth surface, while glue is still wet, insert thumbnail. Press or softly hammer until flush.

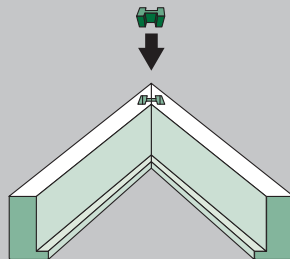

3. Repeat for all 4 corners.

* If using a kit larger than 16" a wire hanger is recommended.

Create any size frame.

- Combine 2 frame kits for your unique size
- Easy to assemble
- Hardware included

nielsen®
Quality